

Multitek[®]

USER MANUAL
LIP-01 DOOR STATION



It obeys the rules of AEEE regulations.

CE

Table of Contents

1. Name and Functions of Each Part.....	1
1.1. Front and Rear Part	1
2. Features	2
3. Packing Contents	2
4. Connection Diagram.....	3
4.1. Wiring Diagram	3
4.2. Electric Lock Connection	3
5. Installation.....	4
5.1. Installation location.....	4
5.2. Wiring and Installation	5
6. Specifications	5

1. Name and Functions of Each Part

1.1. Front and Rear Part

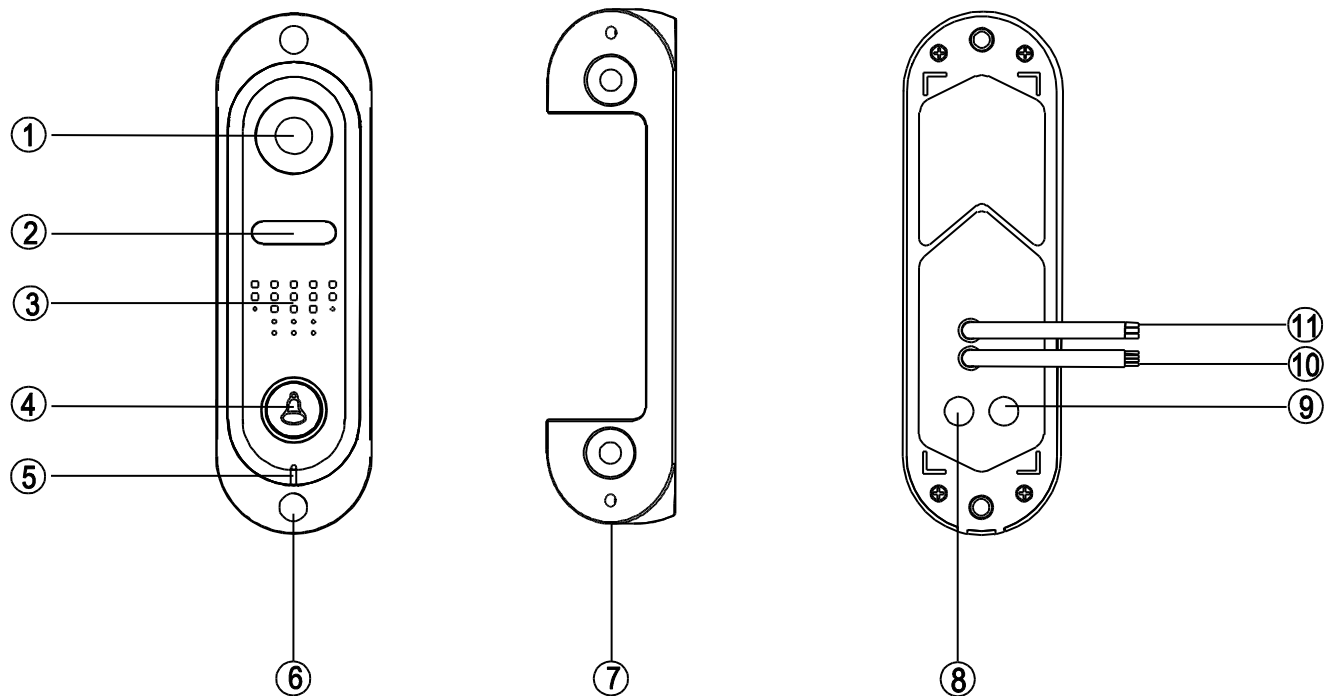

NO.	Part Name
1	Camera
2	LED for night vision
3	Speaker
4	Call button
5	Microphone
6	Metal bracket for surface mounted
7	Metal bracket for wall corner mounted
8	MIC volume adjust
9	Speaker volume adjust
10	Wires for monitor
11	Wires for electronic lock

2. Features

- Pinhole color camera
- 4 Wires in polarity
- Water-proof and dust-proof
- Door lock release
- Microphone and speaker volume adjustable
- LED for night vision
- Surface mount
- IP65 Protection
- 120 Degree viewpoint

3. Packing Contents

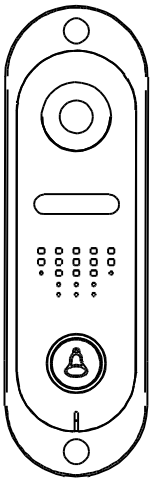

Main Body

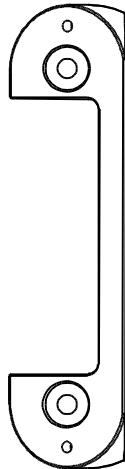

Bracket



Warranty card

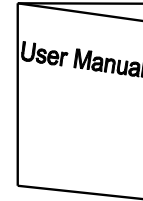

User Manual

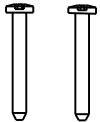

PA M4*30mm
Mounting Screw

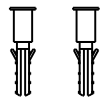

M4*35mm
Plastic Expansion Pipe



PM4*16mm
Fixing Main Body Screw



Rubber Stopper

4. Connection Diagram

4.1. Wiring Diagram

Please be careful to wiring on polarity.

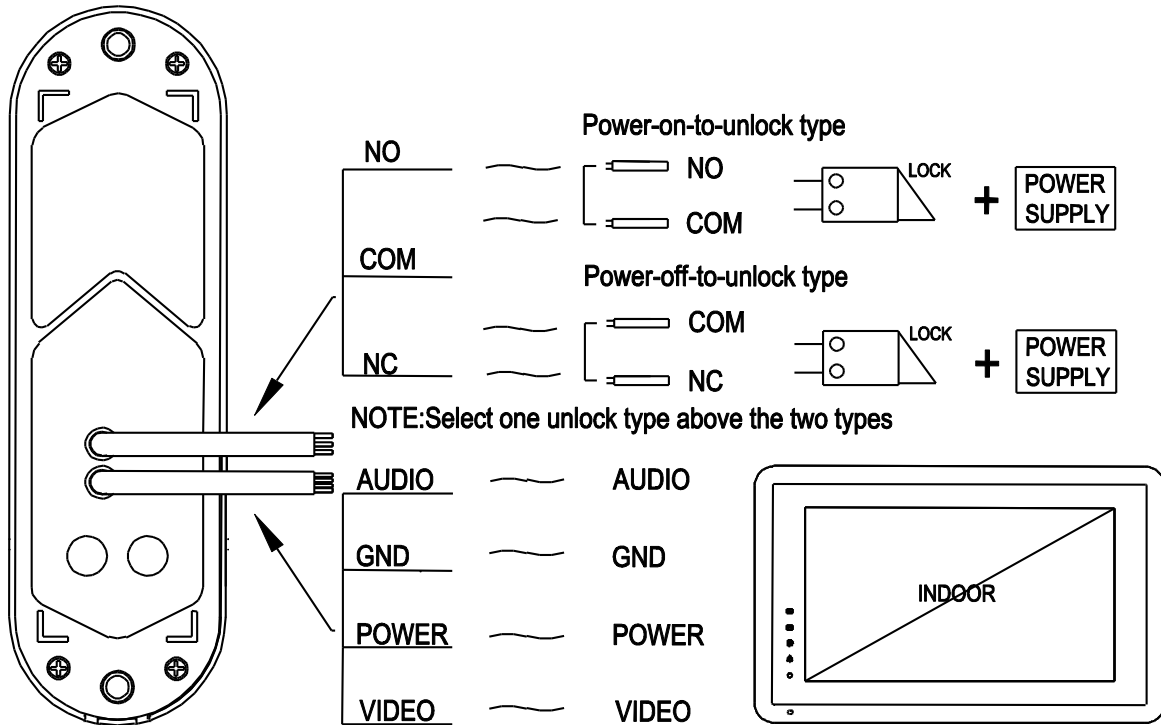

4.2. Electric Lock Connection

◆ Door Lock Controlled with Dry Contact

Note:

1. The external power supply must be used according to the lock.
2. The inside relay contact is restricted to AC or DC 3A.
3. There are two unlock types as the follows:

Type 1: Power-on-to-unlock

Type 2: Power-off-to-unlock

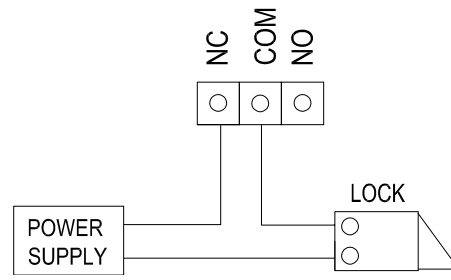
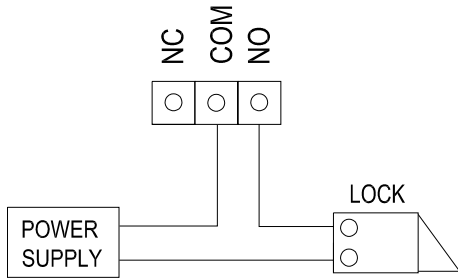

5. Installation

5.1. Installation location

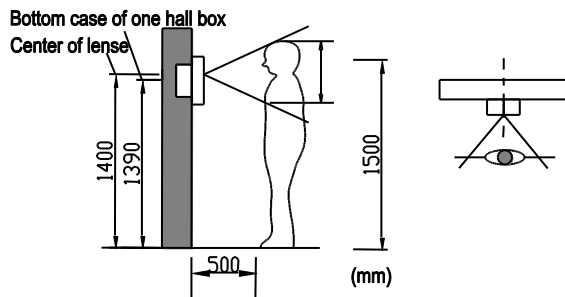

◆ Camera installation location

Standard installation height of outdoor station: lens's height is about 1,400mm above the floor; in this case, camera stack center is about 1,390mm above ground level.

◆ Caution of Camera Installation

Avoid installing camera exposed to direct ray of light (and sun).

Beware backlight and darkness of visitor's face, which makes identification difficult.

Avoid installing camera in places such as the following picture.

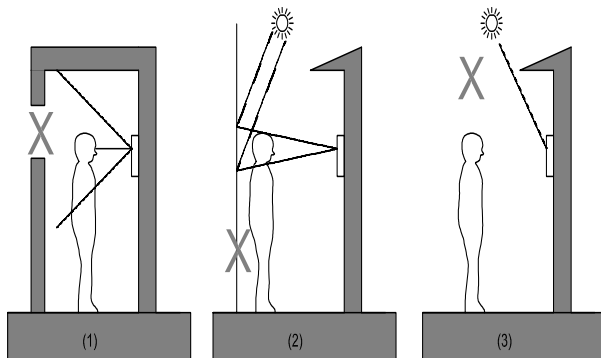

- 1) Place illuminating sky as background
- 2) Place with white wall reflecting direct ray of light
- 3) Place with direct ray of light

5.2. Wiring and Installation

There are two ways to install the doorbells:

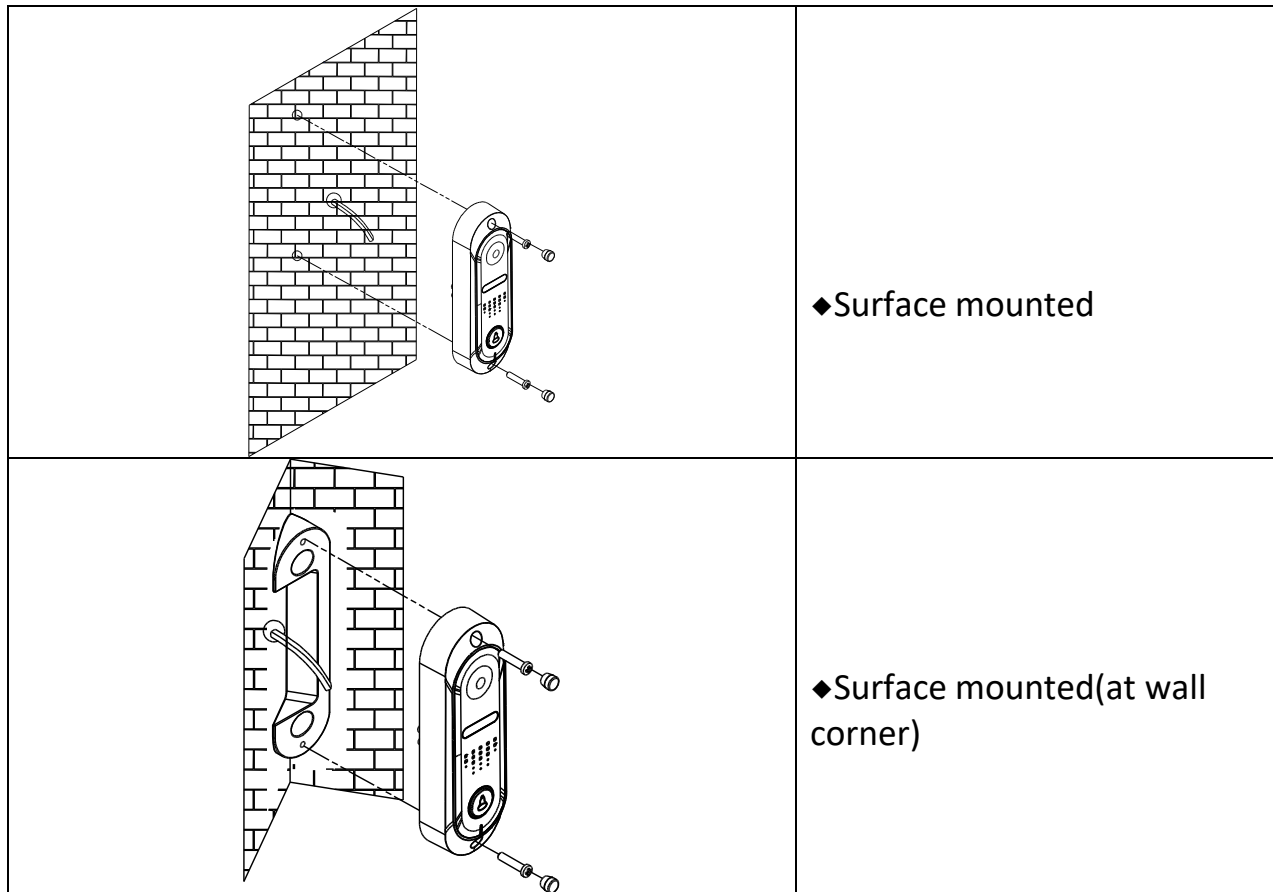

6. Specifications

Wiring	4 Wire Monitor / 2 Wire Electronic lock	
Lighting	LED for night vision	
Operation temperature	-40 ~ 55 °C	
Weight (g)	With bracket	420g
	Main body	285g
Dimensions (mm)	With bracket	140.4(H) x 40.4(W) x 39.1(D)
	Main body	140.4(H) x 40.4(W) x 21(D)